



HOTEL NEW OTANI TOKYO

Your Best Choice for a Successful Event



The New Otani



HOTEL NEW OTANI TOKYO



Hotel New Otani Tokyo opened in 1964 to welcome guests visiting our city for the 18th Olympic Games. Since then, it has led the hotel industry in our country, serving as the main venue for three G7 Summit meetings and welcoming dignitaries from around the world. With a diverse selection of guest rooms, 37 restaurants and bars, 33 banquet rooms, shopping arcades, and first-class service and hospitality, Hotel New Otani Tokyo offers the best platform to lead your event to success.



During construction, 1964



At the time of opening in 1964



The 12th G7 Summit Meeting, 1986



Official Dinner, Imperial Enthronement Ceremony, 1990



Official Dinner, Imperial Enthronement Ceremony, 2019

JAPANESE GARDEN



The hotel's 10-acre Japanese garden boasts a history of more than 400 years, and in the past has been the property of prominent samurai lords. Despite its location in the center of Tokyo, the garden's six-meter-high waterfall, koi pond, verdant trees and seasonal flowers offer a moment of serenity and repose to those who stroll its paths.

Nighttime Illumination: from 30 minutes before sunset to midnight

Access

Hotel New Otani Tokyo is located in the center of the city, with four stations on seven railway lines nearby providing convenient access to areas throughout Tokyo.

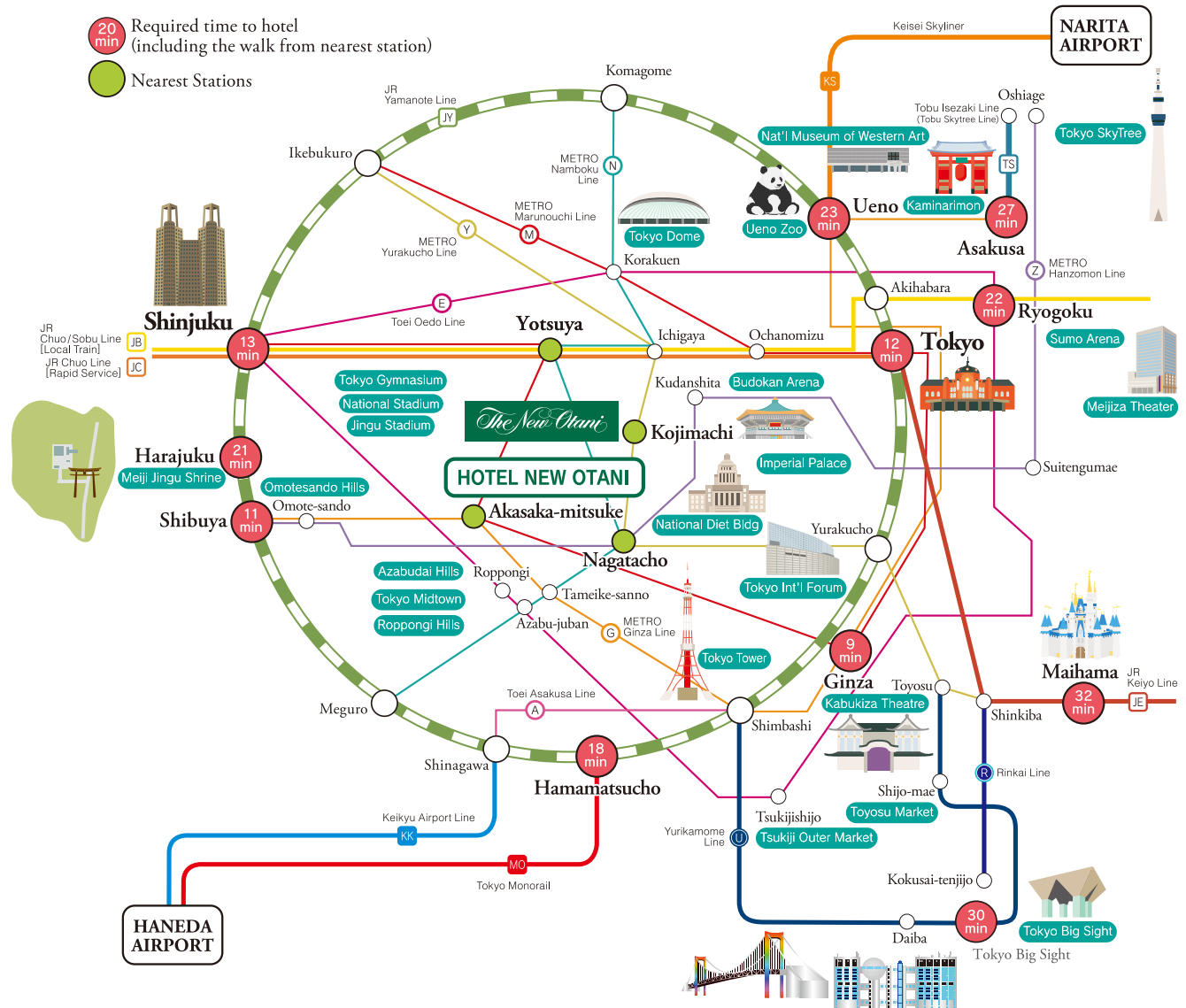

Access from Airports

From Haneda Airport

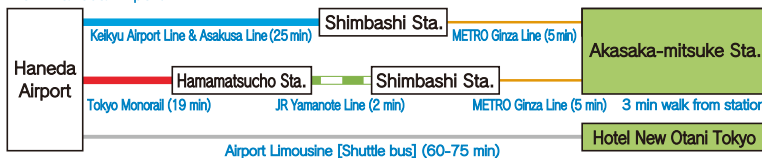

From Narita Airport



Access by Shinkansen (bullet train)

From Tokyo Station

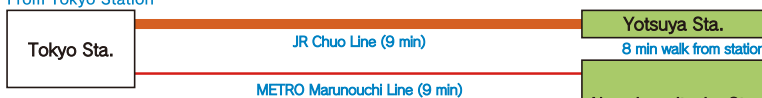

From Shinagawa Station



Access by taxi



Nearest Stations

[Akasaka-mitsuke] METRO Ginza & Marunouchi Lines, 3 min
 [Nagatacho] METRO Hanzomon & Namboku Lines, 3 min
 [Yotsuya] JR Chuo & Sobu Lines, METRO Marunouchi & Namboku Lines, 8 min
 [Kojimachi] METRO Yurakucho Line, 6 min



Parking

A total of 760 parking spaces are available within the complex. (Normal fee ¥500/30 min, free of charge for staying guests.)

Bus spaces also available. (Outside The Main building.)
 (Loading/unloading area also located outside the Garden Tower.)

Location

Hotel New Otani Tokyo is surrounded by four major areas within the city, each with distinctive characteristics and all within walking distance.

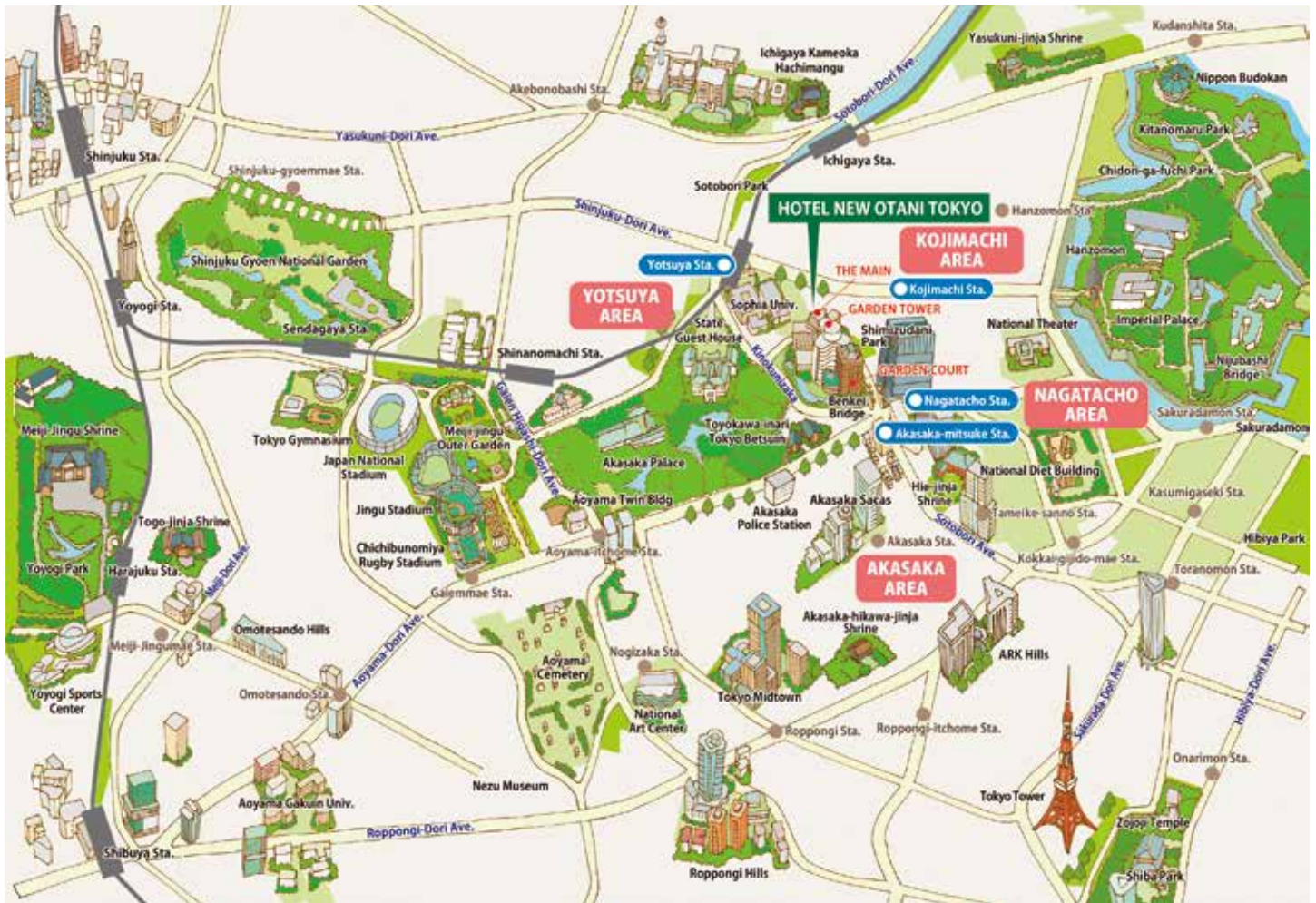

Akasaka Area

Places of Interest

Hie-jinja Shrine, Akasaka Sacas (theaters, restaurants, and shops), etc.



Photo by courtesy of Chiyoda City Tourism Association
Hie-jinja Shrine

Yotsuya Area

Places of Interest

State Guest House, Akasaka Palace, etc.



State Guest House

Nagatacho Area

Places of Interest

National Diet Building, National Theater, etc.



Photo by courtesy of Chiyoda City Tourism Association
National Diet Building

Kojimachi Area

Places of Interest

Shimizudani Park, Imperial Palace, etc.



Photo by courtesy of Chiyoda City Tourism Association
Imperial Palace (Chidorigafuchi Moat)

The history of Kioi-cho

The area where Hotel New Otani Tokyo stands is known as a historic neighborhood where three prominent samurai families once resided. Many historic sites are located in the vicinity, and the hotel's onsite Japanese garden showcases numerous ancient stone lanterns and tree fossils.



The Kioi-cho area on a map printed in 1685
Edo Ooezu, published by Suharaya Mohei

Facilities

A multitude of shops, services and facilities enrich the guests' stay.

The hotel complex is like a town in itself, with innumerable facilities and things to do



The outdoor Garden Pool is one of the largest hotel pools in central Tokyo and opens during the summer and holidays in early May. Private events can be held on certain days.



There are medical/dental clinics on-site, as well as drug stores.



A grocery store and convenience store within the hotel offer groceries including ready-to-eat "bento" meals, perishable and processed foods, beverages, and other daily necessities.



There is a post office with an ATM that dispenses Japanese yen from your overseas bank account.

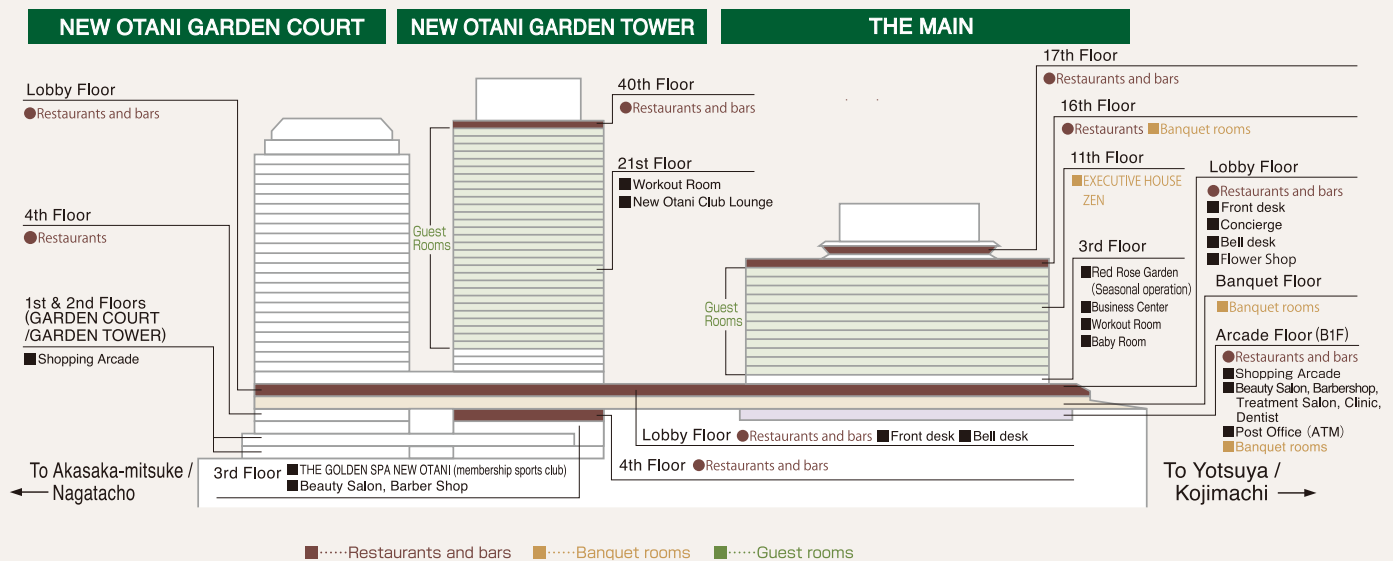

Eco-friendliness, safety, and comfort are all part of New Otani's hospitality



Seismic Upgrade

The Main building, renovated in 2007, as well as the Garden Tower and Garden Court, are all evaluated by certified experts to have the seismic adequacy to withstand earthquakes of upper 6.

Well Water Plant

Abundant groundwater drawn from within premises of the hotel is purified to drinkable quality at an advanced water treatment plant installed in 2009. The plant has a daily capacity of 350 tons, which amounts to three days' worth of drinking water for 9,700 households, and is commissioned by the local government to contribute in times of disasters.

Compost Plant

Our kitchens produce up to five tons of raw refuse every day, all of which is recycled into compost at this on-site plant installed in 1999. The compost is then used at our partner farms to grow vegetables, which return to the kitchen of our employee cafeteria as ingredients, thus completing the recycle chain.

Water Recycling Plant

This plant produces 1,000 tons of recycled water daily from kitchen sewage water, which is utilized in gardens or staff lavatories. Since its installation, consumption of tap water has significantly reduced, thus alleviating the environmental burden.

Wooden Water Tanks

Water tanks made from 7cm-thick American cypress wood planks are installed throughout the Hotel to supply water to guest rooms and restaurants. Their natural antibacterial quality produces safe and clear-tasting water.

Medical Facilities

The hotel complex houses clinics, a dentist, and a pharmacist that can deal with minor medical emergencies. For extreme emergencies, the assistant manager is on duty around the clock and will provide necessary assistance according to the situation.

Health and Beauty

A workout room with exercise equipment is open to staying guests free of charge. A sports club, spa, aesthetic salons, beauty salons are also within the building. The nearby area that includes the Imperial Palace and State Guest House is popular among those who enjoy jogging.

A Wide Array of Facilities

A convenience store, post office with an ATM, florist shop, and an extensive assortment of other facilities offer an even more comfortable and pleasant stay.

Guest Rooms

Three diverse domains house a multitude of room types that cater to each and every need.

*More room types are available. Please inquire.



EXECUTIVE HOUSE ZEN

Ultimate luxury in harmony with nature

EXECUTIVE HOUSE ZEN is located on the 11th and 12th floors of "THE MAIN" building at Hotel New Otani Tokyo. The fundamental design of sophisticated décor is guided by the spirit of Zen—awakening one's inner nature, compassion and wisdom. The "savoir-faire" of our experienced staff will welcome every guest with warm-hearted hospitality.



Garden Suite MUSOU-AN (115m²/1,237.9ft²)

Deluxe



45m²/484.3ft² and up



Suites



67m²/721.1ft² and up



Standard



36m²/387.5ft²



*Room layouts and décor vary.

Hospitality at EXECUTIVE HOUSE ZEN

- Exclusive check in & out at the ZEN LOUNGE
- Exclusive concierge services and 24-hour hotline support



- Complimentary use of membership sports club "The Golden Spa New Otani"
- Free parking in specially reserved areas
- Complimentary use of conference rooms in the Business Center (2 hours)

- Complimentary drinks & light meals in the ZEN LOUNGE
Exquisite items that form the core of Hotel New Otani Tokyo's dining experience are offered buffet style, six times a day.



Breakfast
8:00am-10:00am
Lunch
Noon-2:00pm
Hors d'Oeuvres
5:30pm-8:00pm

Morning Snack
10:00am-Noon
Afternoon Tea
2:30pm-4:30pm
Nightcap and Chocolates
8:00pm-9:30pm



In Forbes Travel Guide 2025, EXECUTIVE HOUSE ZEN is honored with five stars and "The Main" with four stars.



THE MAIN

Experience true comfort in first-class hospitality and service founded on a long-established tradition.



Standard

36m²/387.5ft²

The full-height windows offer stunning views that include the State Guest House and our Japanese garden.

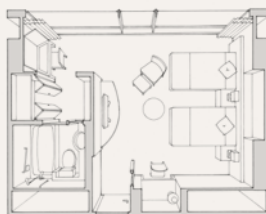

Quality Double



26m²/279.8ft²



Deluxe



45m²/484.3ft² and up

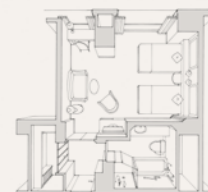

Suites



71m²/764.2ft² and up



*Room layouts and décor vary.

Shin-Edo Rooms

The Shin-Edo rooms are equipped with a cypress-wood bathtub that emanates a relaxing aroma. Experience Japanese hospitality enriched with tradition and culture.



"Shin-Edo" Premium Suite

128m²/1,378ft²

The Premium Suite accommodates up to four persons by connecting the "Shin-Edo" Suite and adjacent room.



"Shin-Edo" Single Room

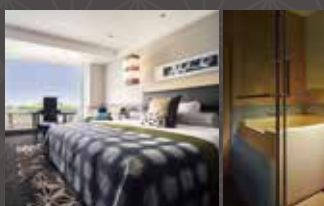

26m²/279.9ft²



"Shin-Edo" Standard Room



36m²/387.5ft²



"Shin-Edo" Deluxe Room



45m²/484.4ft²



Guest Rooms



NEW OTANI GARDEN TOWER

Modern comfort and a view from the high-rise offer a moment of relaxation.



Deluxe

50.2m²/540.3ft² and up

Equipped with oversized beds and boasts breathtaking cityscape views.



Standard



27.3m²/293.8ft²



Standard (Triple)



39.7m²/427.3ft²



Suites



74.7m²/804ft² and up



*Room layouts and décor vary.

Start your day with the breakfast of your choice

Breakfast is offered at four restaurants and also through room service



SATSUKI

The Ultimate Breakfast Buffet: an impressive lineup of wholesome yet delectable foods

Lobby fl, THE MAIN bldg



Room Service

Charge up for the day with an elegant breakfast in the serene privacy of your room



TOWER RESTAURANT

Breakfast with a View: the perfect way to start off your day

40th fl, GARDEN TOWER



Kioi NADAMAN

Authentic Japanese breakfast rich with tradition and taste

Lobby fl, GARDEN TOWER



Garden Lounge

Relax in the tranquil ambience generated by the view of the Japanese Garden

Lobby fl, GARDEN TOWER

Guest Services & Facilities

A multitude of convenient services and facilities enrich your stay

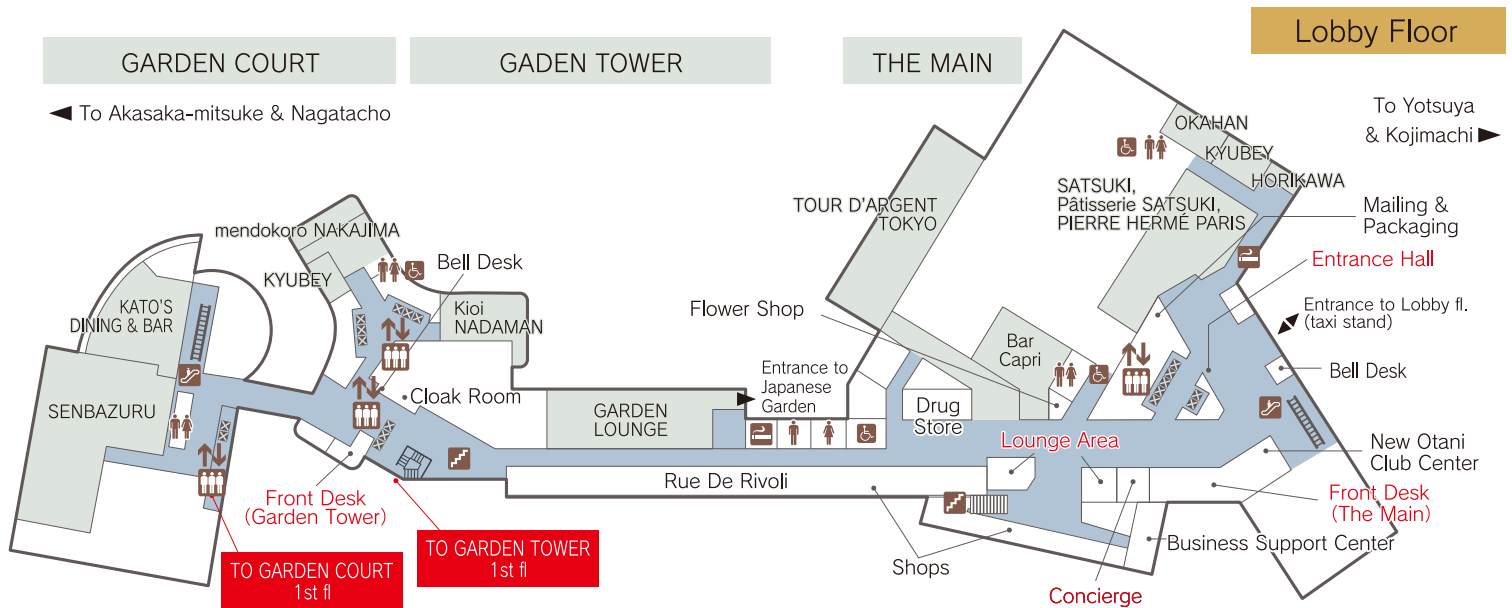

Garden Tower Front Desk

Open 8:00am-10:00pm
Also available to guests staying in The Main building.



Concierge

Open 8:00am-7:00pm
The concierge desk provides support to staying guests including tourist information, arrangements for tickets and reservations, etc.



Lounge Area

A sofa lounge is located near the Main building front desk where guests can sit down while waiting, etc.



The Main Building Front Desk

Open 24 hours
Also available to guests staying in the Garden Tower.



Entrance Hall

Seasonal ikebana arrangements by the Sogetsu school greet the guests.

THE GOLDEN SPA NEW OTANI

(3rd fl, GARDEN TOWER)

Staying guests are welcome to the membership sports club THE GOLDEN SPA NEW OTANI for a visitors' fee.
(Free of charge for guests of EXECUTIVE HOUSE ZEN.)

Pool & gym: weekdays 7:00am-9:45pm
weekends & holidays 10:00am-8:45pm

Sauna: weekdays 7:00am-10:00pm
weekends & holidays 10:00am-9:00pm



Indoor Pool



Dry Sauna



BLACK GYM

Workout Room

(3rd fl, THE MAIN bldg & 21st fl, GARDEN TOWER)

Various exercise equipment are available to staying guests free of charge.

THE MAIN bldg: 5:00am-10:00pm

GARDEN TOWER: 6:00am-9:00pm



Workout Room (THE MAIN bldg)



Workout Room (GARDEN TOWER)

Business Center

(3rd fl, THE MAIN bldg)

Conference rooms (separate fee required) and workstations with PCs (free of charge) are available to staying guests only.

Conference rooms: 10:00am-6:00pm

Workstations: Open 24 hours

Meetings & Banquets

A total of 33 banquet venues of various sizes cater to any event, from international conventions to small gatherings



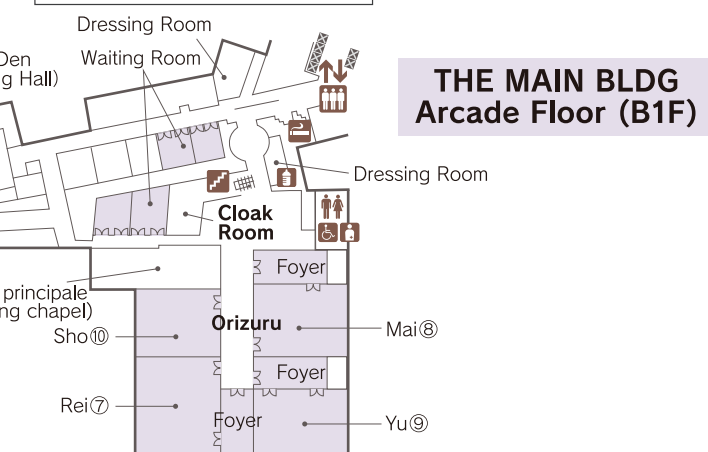
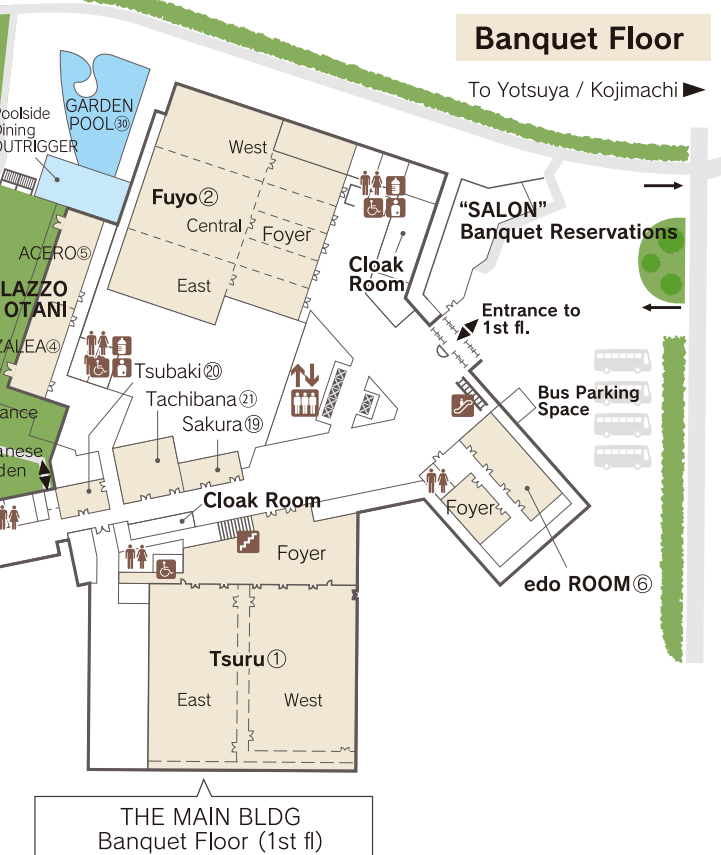
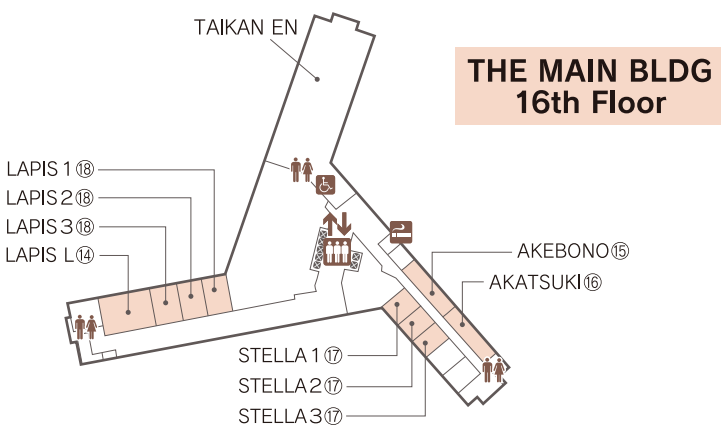
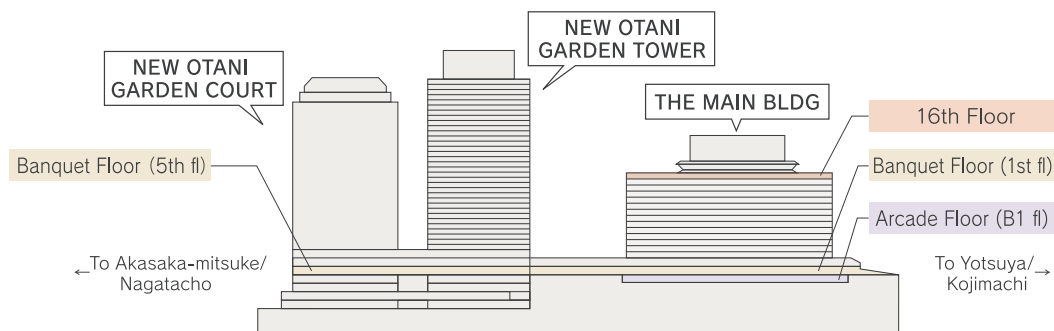

Large-size Banquet Rooms

Name	Location	Space (m ²)	Ceiling Height (m)	Capacity			
				Seated	Buffet	Classroom	Theater
Tsuru ①	Total	1,992	—	1,150	2,500	1,200	2,184
	East	850	5.7	400	800	504	1,023
	West	965	5.7	540	1,100	560	1,200
	(Foyer)	460	3.2	—	—	—	—
Fuyo ②	Total	1,124	—	630	1,500	784	1,404
	East	317	7.6	160	200	192	340
	Central	490	7.6	250	350	336	544
	West	317	7.6	160	200	192	340
	(Foyer)	625	2.9	—	—	—	—
Hō ③	Total	722	—	420	500	540	1,014
	East & Central	462	4.2	260	350	310	585
	East/West	234	4.2	110	140	126	240
	Central	217	4.2	90	130	112	220
	(Foyer)	151	3.6	—	—	—	—

Medium-size Banquet Rooms

Name	Location	Space (m ²)	Ceiling Height (m)	Capacity			
				Seated	Buffet	Classroom	Theater
PALAZZO OTANI	Total	340	3.2	160	220	192	320
	AZALEA④	170	3.2	80	100	88	170
	ACERO⑤	170	3.2	80	100	88	170
	edo ROOM⑥	232	3.3	100	150	150	280
Orizuru	Rei⑦	314	3.0	180	230	200	360
	Mai⑧	256	3.0	140	150	160	300
	Yu⑨	243	3.0	110	140	152	270
	Sho⑩	217	3.0	110	130	128	240
Suihō⑪	GARDEN TOWER Banquet Floor	267	3.1	130	150	200	286
Sirius⑫	GARDEN COURT Banquet Floor	229	3.3	100	140	124	215
Aries⑬	GARDEN COURT Banquet Floor	180	3.4	70	120	102	175
LAPIS L⑭	THE MAIN bldg 16th Floor	147	2.2	60	80	60	100

Small-size Banquet Rooms

Name	Location	Space (m ²)	Ceiling Height (m)	Capacity			
				Seated	Buffet	Classroom	Theater
AKEBONO⑮/AKATSUKI⑯	THE MAIN bldg 16th Floor	63	2.2	10	—	—	—
STELLA⑰ 1/2/3	THE MAIN bldg 16th Floor	46	2.2	10	—	16	30
LAPIS⑱ 1/2/3	THE MAIN bldg 16th Floor	73	2.2	30	40	32	60
Sakura⑲	THE MAIN bldg Banquet Floor	89	3.0	—	—	—	—
Tsubaki⑳	THE MAIN bldg Banquet Floor	65	3.0	—	—	—	—
Tachibana㉑	THE MAIN bldg Banquet Floor	164	3.0	—	—	—	—
Kiku㉒	GARDEN TOWER Banquet Floor	68	3.0	16	—	—	—
Suisen㉓	GARDEN TOWER Banquet Floor	58	3.0	30	40	28	50
Asebi㉔	GARDEN TOWER Banquet Floor	49	3.0	20	—	18	40
Yamabuki㉕	GARDEN TOWER Banquet Floor	85	3.0	30	40	40	60
Crescent㉖	GARDEN COURT Banquet Floor	79	3.0	30	40	52	82
Boardroom㉗	GARDEN COURT Banquet Floor	66	3.0	30	30	40	70
Summit East㉘	GARDEN COURT Banquet Floor	40	3.0	10	—	—	—
Summit West㉙	GARDEN COURT Banquet Floor	40	3.0	10	—	—	—

Garden Pool

Name	Location	Space (m ²)	Capacity
GARDEN POOL⑳	Japanese Garden	2,000	50~250

Restaurants & Bars

An extensive selection of restaurants and bars offer diverse dining experiences including Japanese, Western, and Chinese cuisines, and are ideal for working lunches and client dinners.

*Private rooms require separate charges

Western Cuisine

French Cuisine  
TOUR D'ARGENT TOKYO



The one and only branch location of the esteemed Parisian establishment

Lobby fl, THE MAIN bldg
Closed on Mondays and Tuesdays
Private room: 1 (max 30 persons)

International Cuisine  
TRADER VIC'S TOKYO



Enjoy dishes from around the world and tropical concoctions



4th fl, GARDEN TOWER
Closed on Mondays(excl holidays)
Private rooms: 5 (seated 4-50, standing buffet max 80 persons)

Western Cuisine  
BELLA VISTA



Indulge in exquisite dishes with the view from the 40th floor

40th fl, GARDEN TOWER
Private rooms: 2 (6-14 persons)

International Cuisine   Tenant Restaurant
GUN-SHIP



Set sail on a gourmet voyage of delectable cuisine from around the world in a nautical theme decor

4th fl, GARDEN COURT
Private rooms: 6 (4-80 persons)

Western Cuisine   French Restaurant, Café & Bakery Tenant Restaurant
AUX BACCHANALES



A stylish brasserie facing the park, offering casual Parisian esprit and home style French cuisine

1st fl, Shin-Kioicho bldg
Private room: 1 (20-70 persons)

Buffet   Buffet & Bar
VIEW & DINING THE SKY



Take in the 360-degrees panorama of Tokyo and an extensive buffet of freshly prepared items

17th fl, THE MAIN bldg
Private rooms: 2 (2-8 persons)

Buffet Dining   
TOWER RESTAURANT



A delightful buffet and a breathtaking view from the 40th floor

40th fl, GARDEN TOWER

Chinese Cuisine   Chinese Cuisine
TAIKAN EN



Delight in the genuine taste of Shanghai that has been fascinating gastronomists ever since 1964

16th fl, THE MAIN bldg
Private rooms: 5 (6-32 persons)

Steak House/Teppanyaki   Teppanyaki
SEKISHIN-TEI



A counter-style restaurant within the Japanese garden offering prime beef and seafood

Within Japanese garden
(24 seats)

Teppanyaki  
SEISEN-TEI



Succulent beef and fresh seafood prepared right at your table overlooking a koi pond

Within Japanese garden
(18 seats)

Teppanyaki  
MOMIJI-TEI



Enjoy select beef and seafood prepared in the spacious dining room that is ideal for large groups

Within Japanese garden
(40 seats)

Steak House  
RIB ROOM



Wagyu steaks grilled to sizzling perfection at a genteel steak house as old as the hotel itself

Arade fl, THE MAIN bldg

Japanese Cuisine   Japanese Cuisine (Kaiseki)
SENBAZURU



Elaborately-prepared seasonal delicacies and traditional service

Lobby fl, GARDEN COURT
Private rooms: 5 (2-20 persons)

Japanese Cuisine  
KATO'S DINING & BAR



Authentic Japanese cuisine and an extensive selection of sake

Lobby fl, GARDEN COURT
Private rooms: 3 (2-20 persons)

Japanese Noodles  
mendokoro NAKAJIMA



Traditional yet innovative soba and udon dishes and delicacies sought out from all over Japan

Lobby fl, GARDEN TOWER

Japanese Cuisine (Kaiseiki)   Tenant Restaurant
NADAMAN MAIN BRANCH SAZANKA-SO



A time-established restaurant that hosted the official dinner of the 1986 G7 Summit

Within Japanese garden
Private rooms: 5 (2-22 persons)

Japanese Cuisine   Japanese Cuisine/Tempura Tenant Restaurant  
Kioi NADAMAN



Traditional Japanese cuisine, original creations, and a generous view of the Japanese Garden

Lobby fl, GARDEN TOWER
Private rooms: 4 (4-24 persons)

Tempura   Tenant Restaurant
Tempura HORIKAWA



The best of traditional tempura made with fresh seafood and vegetables and specially selected oil



Lobby fl, THE MAIN bldg
Private room: 1 (4-8 persons)

Japanese Cuisine   Tenant Restaurant
RANSEN



Watch the culinary craftsmanship of chefs at work, using select foods from around the country

Arade fl, THE MAIN bldg
Private rooms: 3 (4-12 persons, course order required)

Sukiyaki & Shabu Shabu   Tenant Restaurant
OKAHAN



Traditional sukiyaki and shabu shabu prepared with top quality beef

Lobby fl, THE MAIN bldg
Private rooms: 5 (1-35 persons)

Japanese Cuisine

Sushi KYUBEY

Tenant Restaurant  



Discover the art of sushi at this acclaimed restaurant known as one of the best in Japan
Lobby fl, THE MAIN bldg /
Lobby fl, GARDEN TOWER
Private room: 1 (4-6 persons, Garden Tower branch)

Sushi TSUKIJI SUZUTOMI

Tenant Restaurant  



Offers sushi made from select ingredients including exceptional tuna, in a refined atmosphere
4th fl, GARDEN COURT
Private room: 1 (4-18 persons)

Tonkatsu, Japanese Cuisine FUMIZEN

Tenant Restaurant  



Savor the flavors and textures of expertly-made "tonkatsu" and Japanese fare
Arcade fl, THE MAIN bldg
Private room: 1 (6 persons)

Soba & Eel NIIZU

Tenant Restaurant  



Grilled "unagi" eels with a rich flavor and soft texture, and fresh-made "soba" noodles
Arcade fl, THE MAIN bldg

Japanese Cuisine

Yakitori ISEHIRO

Tenant Restaurant  



A branch of a time-honored "yakitori" restaurant
Arcade fl, THE MAIN bldg
Private room: 1 (4 persons)

Cafe & Lounges

All-day Dining SATSUMI



A selection of carefully prepared items offered from breakfast to dinner or a late evening snack
Lobby fl, THE MAIN bldg

Tea & Cocktails GARDEN LOUNGE



A spacious and open lounge with a breathtaking view of the Japanese garden
Lobby fl, GARDEN TOWER

Pizza & Café TOM CAT

Tenant Restaurant  



Offers pastas, pizzas, curries, and appetizers in a casual and modern atmosphere
Arcade fl, THE MAIN bldg
Private rooms: 2 (8-40 persons)

Cafe & Lounges

Café PESHAWORL

Tenant Restaurant  



A quaint and cozy coffee shop furnished with antique pieces, serving nel drip French roast coffee
Arcade fl, THE MAIN bldg

Café CaFé LA MILLE

Tenant Restaurant  



Sit back in the warm décor with a cup of expertly-brewed aromatic coffee and delicate cakes
2nd fl, GARDEN TOWER

Café MILK HALL

Tenant Restaurant 



A food-court style restaurant offering ramen, pastas, curries, and set meals at affordable prices
4th fl, GARDEN COURT
Closed on weekends and holidays

Café TULLY'S COFFEE

Tenant Restaurant  



A selection of gourmet coffees from around the world, pastries, sandwiches, and sweets
2nd fl, GARDEN COURT

Bar

Bar Bar Capri





Expressionist paintings by Paul Aizpiri adorn the walls and live piano music entertains the patrons
Lobby fl, THE MAIN bldg
Private rooms: 2 (10-28 persons)

Café & Bar TOWER CAFÉ





Indulge in an evening in style with a spectacular view from the top floor of the Garden Tower
40th fl, GARDEN TOWER

Bar sky BAR





Take in the glittering nightscape of Tokyo with an aperitif or after-dinner drink
17th fl, THE MAIN bldg

Bar TRADER VIC'S TOKYO BOATHOUSE BAR



Choose from more than 80 concoctions of tropical drinks including the original Mai Tai
4th fl, GARDEN TOWER
Closed on Mondays(excl holidays)

Bar

Dining Bar KATO'S DINING & BAR





A stylish bar with Japanese design elements and a serene ambience
Lobby fl, GARDEN COURT

Bar RANSEN HANARE

Tenant Restaurant  



Indulge in sommelier-selected wines and Japanese dishes in the tasteful wood and stone décor
Arcade fl, THE MAIN bldg
Closed on Sundays and Mondays

Pastry Bread & Cake Patisserie SATSUMI



Cakes and breads created by Hotel New Otani's Executive Chef Shinsuke Nakajima
Lobby fl, THE MAIN bldg

French Patisserie PIERRE HERMÉ PARIS



The first-ever pastry boutique of the renowned PIERRE HERMÉ PARIS
Lobby fl, THE MAIN bldg

Seasonal Attractions at Hotel New Otani Tokyo

Our 400-year-old Japanese Garden is rich with flowers and foliage that bloom and change colors by the season. Events are held from time to time.

Events

March	April	May	June	July	August	September	October	November	December	January	February
		GARDEN POOL						Exterior Illumination			
	Golden Week Holiday Events			Night Pool				Christmas Tree Decoration			
Sakura Events					Summer Events			Christmas Events		New Year's Events	
		Red Rose Garden					Red Rose Garden				
			●Sanno Matsuri (Hie-jinja Shrine) *One of Japan's three major festivals held in Tokyo			●Jingugaien Fireworks Festival					

Japanese garden

March	April	May	June	July	August	September	October	November	December	January	February
Cherry Blossoms	Rhododendron		Hydrangea	Crepe Myrtle		Sasanqua Camellia		Autumn Foliage			
Camellia		Satsuki Azalea & Sweet Flag				Japanese Clover & Silver Grass		Camellia Hiemalis			
	Azalea										

Two trees in the garden, a Japanese Nutmeg and Yew Plum Pine, are assessed to be over 200 years old, and have been designated by the Chiyoda ward as Natural Treasures.

Nighttime illumination supervised by globally-renowned lighting artist Motoko Ishii is on show after dark in the Japanese garden around the year.
(Nighttime illumination: from 30 minutes before sunset to midnight)



During the cherry blossom season, the lobby and restaurants are also decorated with fresh cherry branches. Nearly 20 breeds of cherry bloom at slightly different timings in the Japanese garden, such as the weeping cherry (late March to early April), Yoshino cherry (late March to early April), and yaezakura (late April to early May), so viewers can appreciate their beauty for a longer period.

The 2,000m² outdoor Garden Pool is equipped with three pools of various depths that may be enjoyed by guests of all ages, offering a tropical resort ambience by day and a stylish night scene after dusk. During off-season periods, the poolside can be used as a venue for client parties, weddings, press events, etc.

The historic 10-acre garden starts to display signs of autumn from mid-November, with the leaves turning bright red, orange, and yellow, and the feathery plumes of silver grass swaying in the wind. The restaurants within the hotel offer rich blessings of the harvest season such as chestnuts and matsutake mushrooms.

From November to February, the perimeter of the hotel is adorned with over 130 thousand fairy lights that shine and glitter through the clear winter air. During the holiday period, more than 30 decorated trees of various sizes and themes boost the festive mood throughout the grounds and in the lobby and restaurants.

The New Otani
NEW OTANI HOTELS

Hotel New Otani Tokyo, Hotel New Otani Makuhari, Hotel New Otani Osaka, New Otani Inn Sapporo, Hotel New Otani Nagaoka, NASPA New Otani (Echigo Yuzawa), New Otani Inn Tokyo (Osaki), New Otani Inn Yokohama Premium, Hotel New Otani Takaoka, Hotel New Otani Tottori, Hotel New Otani Hakata, Hotel New Otani Saga, Hotel New Otani Chang Fu Gong (Beijing)

Associate Hotels
The Italia-Ken (Niigata), Kanazawa New Grand Hotel

The New Otani

HOTEL NEW OTANI 4-1 KIOI-CHO, CHIYODA-KU, TOKYO 102-8578, JAPAN Tel: +81-3-3265-1111
newotani.co.jp/en

Information in this brochure is as of April 2025. 202504TE1200